

First Floor, 1,718 square feet

A generous-sized fireplace in a generous-sized room.

From kids' lunch box storage areas, to spice drawers, optional Wolf® cookstove and English-style cabinets, our kitchen packages are a feast of intelligent ideas.

A dramatic bank of windows, repeated higher. Nicely affecting the wow factor.



A nine-foot ceiling is called "soaring" in some homes. This one is twice that height.

Room that can be a library, or with its own bath, a workout room. Hit the showers.

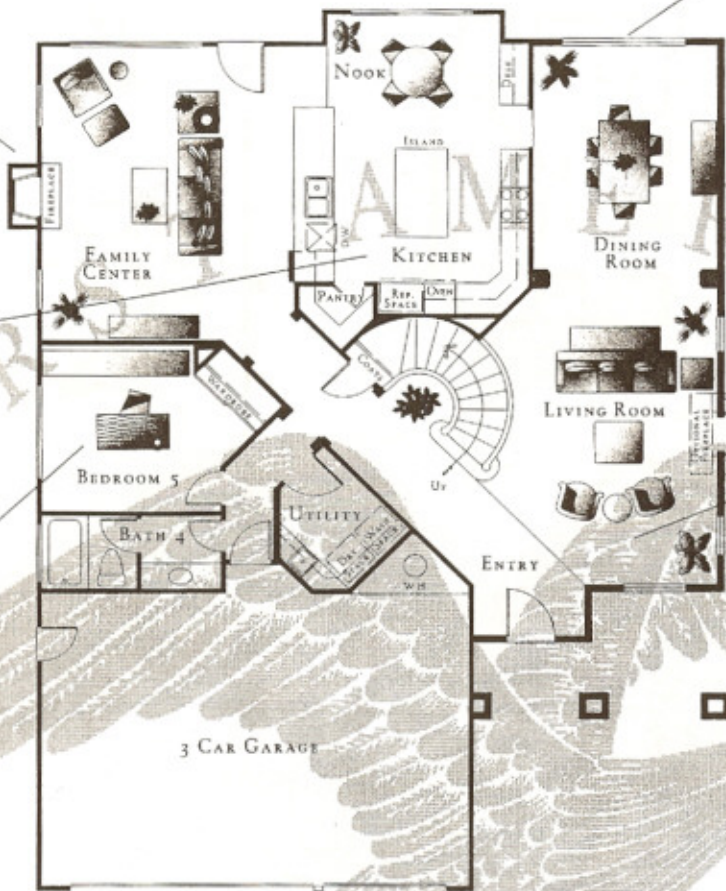

"THE VON GRAVEN"

CANTATA

Second Floor, 1,498 square feet

A fireplace to end the evening, and a balcony to take in the morning. What doesn't this master suite have?

You could opt to open this up as a retreat for the master suite or a nursery, as shown here.

Imagine:  
You have several different options with this space, to fit your family just as you like.

Under the counter, you could add a refrigerator, and have your morning juice (or evening Chardonnay) right here.

A "his-and-hers" closet. But who says it can't be just yours?

This could be a terrific bonus room, as shown in our model.

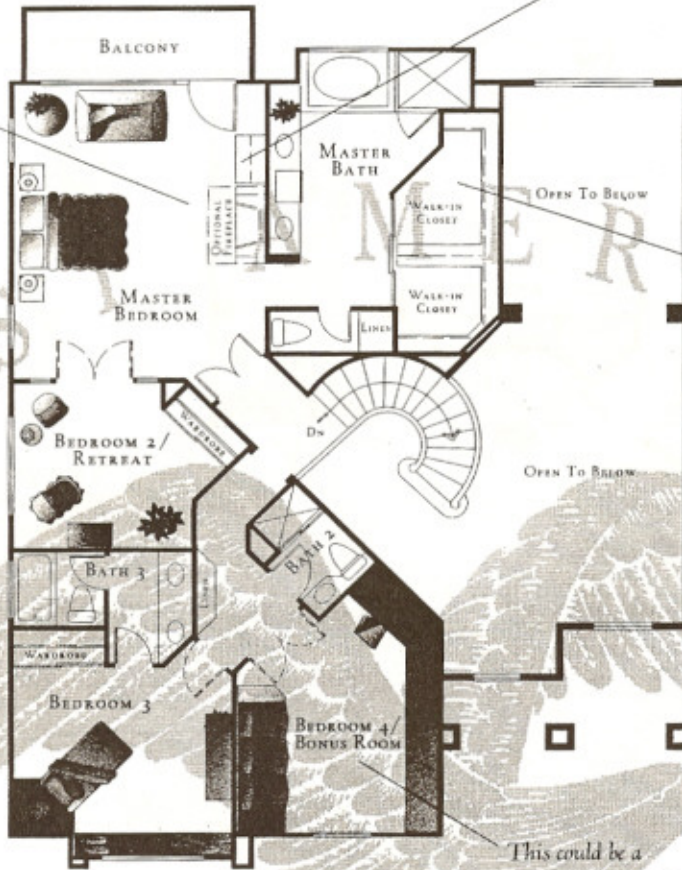

"THE VON GRAVEN"

CANTATA