

THE TERRACE

Plan 1

(Not A Model)

- Single-Story • Three Bedrooms
- Or Two Plus Den Option
- Two And One-Half Baths
- Oversized Two-Car Garage
- 2,320 Square Feet

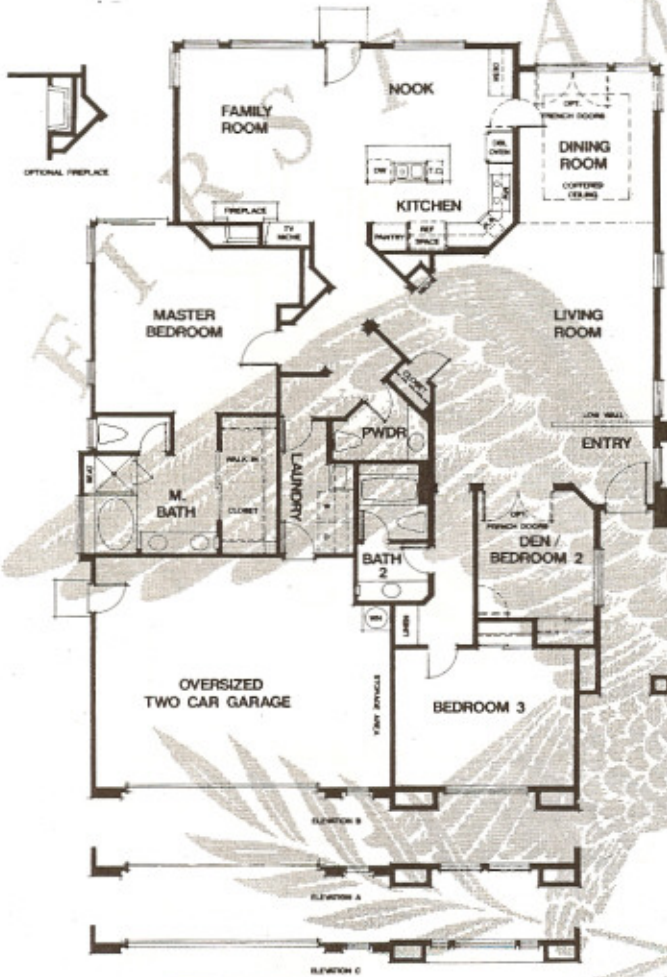

Perfect for active adults and young families, The Terrace offers a large country kitchen with center work island, nook and adjacent family room with woodburning fireplace and TV niche. This home offers a spacious master suite with a large walk-in closet and an optional fireplace. There is a convenient interior laundry room and a host of included amenities. For nearly 70 years Warmington has been committed to building homes of the highest caliber and to providing unsurpassed customer service. Ask about our assistance programs that can help you with the purchase of a new Warmington home.



Exterior elevations are similar to those shown on the facing page for Plan 3.